

# Optima® Flushometers

Old Royal® until 05/09, current Sloan/Regal®

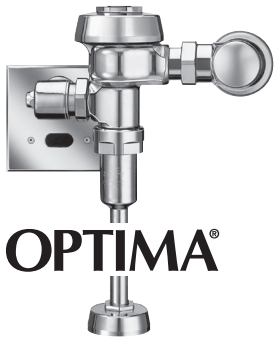

**OPTIMA®**

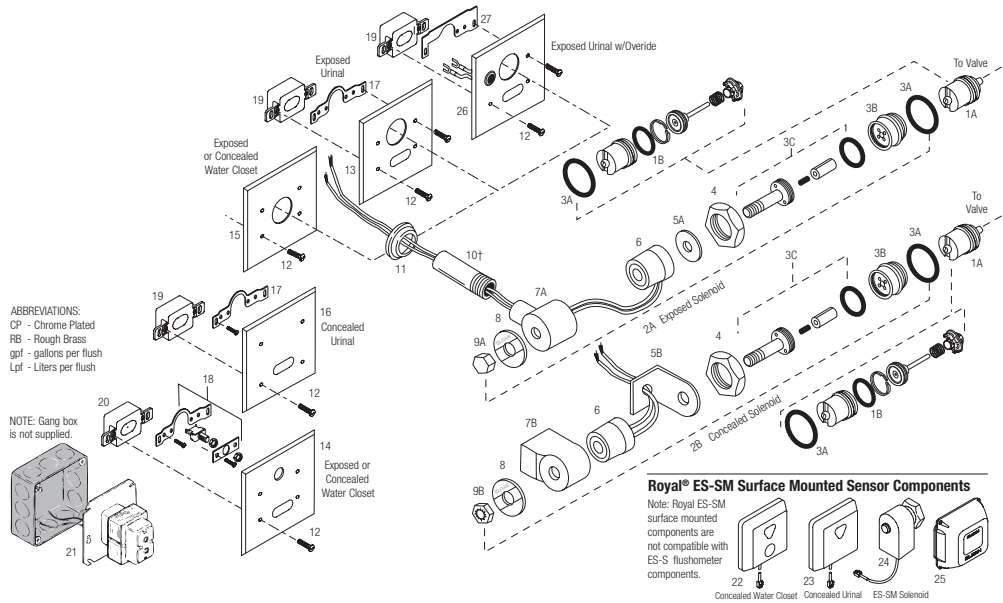

## SOLENOID/SENSOR PARTS AND ASSEMBLIES LIST

Item				Item			
No.	Code No.	Part No.	Description	No.	Code No.	Part No.	Description
1A.	<b>3305043</b>	EL-128-A	Actuator Cartridge Assembly Repair Kit Includes Spring, Plunger Guide, Solenoid Valve Seat, Valve Piston Assembly, and O-Ring (also available for ES-SM flushometers)	9A.	<b>0305125</b>	EL-101	CP Nut for Solenoid (exposed installation)
1B.	<b>0305135</b>	EL-110	O-Ring	9B.	<b>0305167</b>	EL-166	Housing Nut for Solenoid (concealed installation)
2A.	<b>0305328</b>	EL-124-1	120V only (no sensor)	10.	<b>0306249</b>	F-15	Tail †
	<b>3305044</b>	EL-1029-A	CP Cartridge/Solenoid Kit EL-124-1 (120V) and EL128-A		<b>0305145</b>	EL-123-A	Old Style ESS 24V course thread (120V also)
	<b>0305329</b>	EL-124-2	24 VAC Solenoid Assembly (exposed installation) Includes Handle Coupling, 24 VAC Coil, Face Plate for 24 VAC Solenoid, Solenoid Adapter, Solenoid Shaft Assembly, Nut for Solenoid, Solenoid Housing, Solenoid Flux Plate, and O-Ring		<b>0305337PK</b>	EL-226	1-1/4" Extension for EL-123-A course thread
	<b>3305045</b>	EL-1028-A	CP Cartridge/Solenoid Kit EL-124-2 (24V) and EL128-A	11.	<b>0345150</b>	EL-431-A	CP Flange Assembly (exposed installation)
2B.	<b>0305330</b>	EL-138-1	120V only (no sensor)		<b>0305139</b>	EL-176-A	Old Style ESS 24V course thread (120V also)
	<b>0305331</b>	EL-138-2	24 VAC Solenoid Assembly (concealed installation) Includes Handle Coupling, 24 VAC Coil, Face Plate for 24 VAC Solenoid, Solenoid Adapter, Solenoid Shaft Assembly, Nut for Solenoid, Solenoid Base Plate and Solenoid Cover Assembly	12.	<b>0305152</b>	EL-152	CP Screws (requires four screws per cover plate)
3A.	<b>0337086</b>	D0-22	O-Ring	13.	<b>0305151</b>	EL-151	CP Cover Plate for Sensor and Solenoid Operator (Urinal only)
3B.	<b>0305132</b>	EL-104	RB Adapter for Solenoid	14.	<b>0305219</b>	EL-201	CP Cover Plate for Sensor and Override Button (Closet only)
3C.	<b>0305165</b>	EL-163-A	Solenoid Shaft Assembly Includes Gasket, Plunger, Plunger Spring, and Solenoid Shaft	15.	<b>0318066</b>	HY-66	CP Cover Plate for Solenoid Operator (Closet only)
4.	<b>0301082</b>	A-6	CP Handle Coupling (exposed installation)	16.	<b>0305161</b>	EL-161	CP Cover Plate for Sensor
5A.	<b>0305166</b>	EL-164	Solenoid Flux Plate (exposed installation) fine thread	17.	<b>0305323</b>	EL-168-A	Yoke Assembly (Urinal only)
5B.	—	EL-542	N/A Separately	18.	<b>0305324</b>	EL-141-A	Override Switch and Yoke Assembly (Closet only)
6.	<b>0305119</b>	EL-165-1	120 V Coil	19.	<b>3305620</b>	EL-1500	Urinal Sensor Replacement Kit (Urinal only)
	<b>0305118</b>	EL-165-2	24 VAC Coil	20.	<b>3305621</b>	EL-1500-L	Closet Sensor Replacement Kit (Closet only)
7A.	<b>0345120</b>	EL-162-2	CP Solenoid Housing (exposed installation) fine thread	21.	<b>0345154</b>	EL-154	Transformer (120 VAC) (also available for ES-SM flushometers) 50 VA plate mount
	<b>0305164</b>	EL-162-1	CP Solenoid Housing (120V) course thread also used on pre-2001 24 V		<b>0345999</b>	EL-342	Transformer (240 VAC) (also available for ES-SM flushometers) 50 VA plate mount
7B.	<b>0305336</b>	EL-541-A	Solenoid Cover Assembly (Includes Flux Plate)	22.	<b>3345047</b>	EL-461	Surface Mounted Sensor and Override Button Assembly (closet only)
8.	<b>0305127</b>	EL-102-2	Face Plate for 24 VAC Solenoid (exposed installation)	23.	<b>3345048</b>	EL-497	Surface Mounted Sensor Assembly (urinal only)
				24.	<b>0305802</b>	EL-297	Solenoid Assembly
				25.	<b>3365003</b>	ETF-492-A	Control Module
				26.	<b>0345266</b>	EL-566-A	Exposed Plate with Override Button (Urinal only)
				27.	<b>0345267</b>	EL-567-A	Yoke Assembly for EL-566-A
				28.	<b>3345080</b>	EL-1026-A	ESS to TMO Retrofit Kit (Exposed)*
				—	<b>0305148</b>	EL-227	Repair Tool Kit for EL-163-A Repair Kit
				—	<b>0345016</b>	EL-387-A	Override Button Replacement for EL-566-A
				—	<b>3345021</b>	EL-1010-A	O-ring Repair Kit*

† NOTE: For exposed & concealed solenoids manufactured before 2001 or not shown here, consult factory for individual part assembly.

\* Not Shown