

**CODE NUMBER**

3326009

**DESCRIPTION**

Standard

**FEATURES**

**MIX-60-A Below Deck Mechanical Water Mixing Valve with the following features:**

- Designed to install under the lavatory
- Supplied with Sloan Optima and Optima Plus faucets that are specified with the "BDM" (Below- Deck-Mixer) variation.
- Installs in place of the Tee fitting supplied with the faucet prior to the solenoid valve
- Equipped with integral check valves at inlets
- 3/8" compression fittings on inlets and outlet
- Compression sleeves and nuts included
- Lever dial adjustment with lock screw: COLD-HOT
- Brass construction
- Chrome plated finish

**NOTES**

All information contained within this document subject to change without notice.



Flow Capacities

	SYSTEM PRESSURE					
	20	30	40	50	60	70
PSI	2.0	2.1	2.2	2.3	2.4	2.5
BAR	1.4	2.1	2.8	3.4	4.2	4.9
GPM	1.75	2.25	2.75	3.0	3.5	4.0
Lpm	6.62	8.51	10.40	11.35	13.25	15.14

**CAUTION!** This is a mechanical hot and cold mixing valve only! It DOES NOT provide automatic control of water temperature. Hot water in excess of 110°F (43°C) is dangerous and CAN CAUSE SCALDING!

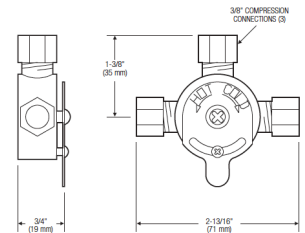

**COMPLIANCES & CERTIFICATIONS**



(cUPC Low Lead Compliant, Proposition 65)

**Sloan 10500 Seymour Ave, Franklin Park, IL 60131**

Phone: 800.982.5839 • Fax: 800.447.8329 • [sloan.com](http://sloan.com)